

75009614	DATA SHEET	
Valid from: 14.01.2019	EPIC[®] KIT H-A 4 SS MTGV M20	

Description

- H-A inserts, easy to service, with screw termination up to 2.5 mm² wire cross section
- The small H-A is used whenever there is minimal space
- Easy cable connection with strait cable entry in the contacts.
- Optimally matched components
- Reduced ordering effort
- No wrong orders



Components of the combination

Article number of the combination

75009614

Housing

H-A 3 MTgv M20 (19512100)

Insert

H-A 4 SS (10431000)

General characteristics

Series

H-A 4

Version

Male

Connection type

Screw termination

Pin-arrangement

4 + PE

Contact diameter

1 mm

Termination cross section

Screw termination: 0,5 – 2,5 mm² (2,5 mm² with wire end sleeve, depending on crimp profile)

Degree of protection (DIN EN 60529)

IP 65 (latched)

Degree of protection (NEMA 250/UL 50E)

12, 4 (latched)

Cycles of mechanical operation

100

Temperature range

-40°C to +125°C, short term up to +125

Materials and surfaces

Housing, base material

Zinc die-casting

surface Housing

Powder-coating, grey

Insert

PA

Contact, base material

Copper alloy

Contact, surface

Hard-silver

Electrical characteristics

Rated Voltage, IEC

400 V

Rated Voltage, UL

600 V

Rated Voltage, CSA

600 V

Rated Impulse Voltage

4 kV

Rated Current, IEC

23 A

Rated Current, UL

10 A

Rated Current, CSA

10 A

Contact Resistance

1,5 - 4 mOhm

Creator: JOKR1/PDP	Document: DB75009614EN	Page 1 of 3
Released: IVSE1/PDP	Version: 01	

We reserve all rights according to DIN ISO 16016.

PD 0019/05_04.18EN

75009614	DATA SHEET	
Valid from: 14.01.2019	EPIC® KIT H-A 4 SS MTGV M20	

Degree of Soiling

3

Approvals

VDE-Approval, VDE-REG.-Nr.

B437

UL File Number

E75770

CSA File Number

053004



Standards

Safety Standard

IEC 61984; UL 1977; CSA-C22.02

Technical Drawings

Housing

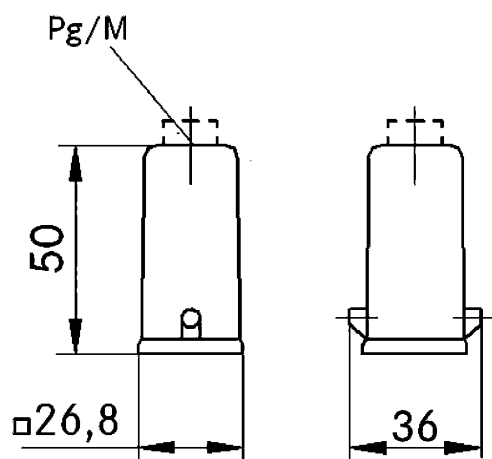

Insert

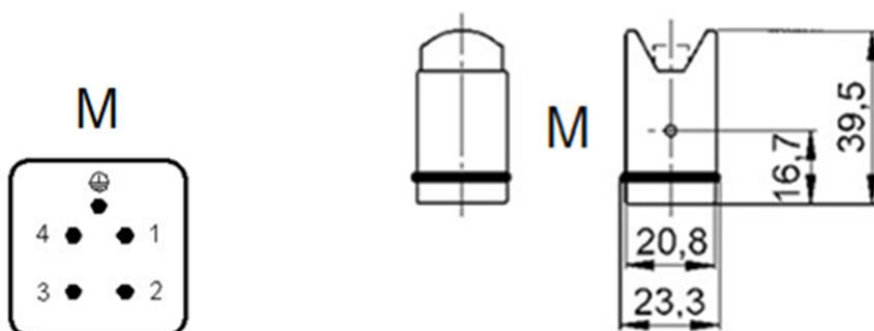

75009614	DATA SHEET	
Valid from: 14.01.2019	EPIC® KIT H-A 4 SS MTGV M20	



Industrial machinery and plant engineering



Mechanical resistance



Robust



Waterproof



Assembly time



Space requirement

Info

Compact, robust metal housings size H-A 3
Robust power supply connector
Straight cable entry into the contacts

Application range

Machine and equipment manufacturing
Control engineering
Electronic laboratory

Remark

Photographs are not to scale and do not represent detailed images of the respective products.

Creator: JOKR1/PDP Released: IVSE1/PDP	Document: DB75009614EN Version: 01	Page 3 of 3
-------------------------------------------	---------------------------------------	-------------

75009616	DATA SHEET	
Valid from: 14.01.2019	EPIC® KIT H-A 4 SS MTS M20	

Description

- H-A inserts, easy to service, with screw termination up to 2.5 mm² wire cross section
- The small H-A is used whenever there is minimal space
- Easy cable connection with strait cable entry in the contacts.
- Optimally matched components
- Reduced ordering effort
- No wrong orders



Components of the combination

Article number of the combination	75009616
Housing	H-A 3 MTs M20 (19512300)
Insert	H-A 4 SS (10431000)

General characteristics

Series	H-A 4
Version	Male
Connection type	Screw termination
Pin-arrangement	4 + PE
Contact diameter	1 mm
Termination cross section	Screw termination: 0,5 – 2,5 mm ² (2,5 mm ² with wire end sleeve, depending on crimp profile)
Degree of protection (DIN EN 60529)	IP 65 (latched)
Degree of protection (NEMA 250/UL 50E)	12, 4 (latched)
Cycles of mechanical operation	100
Temperature range	-40°C to +125°C, short term up to +125

Materials and surfaces

Housing, base material	Zinc die-casting
surface Housing	Powder-coating, grey
Insert	PA
Contact, base material	Copper alloy
Contact, surface	Hard-silver

Electrical characteristics

Rated Voltage, IEC	400 V
Rated Voltage, UL	600 V
Rated Voltage, CSA	600 V
Rated Impulse Voltage	4 kV
Rated Current, IEC	23 A
Rated Current, UL	10 A
Rated Current, CSA	10 A
Contact Resistance	1,5 - 4 mOhm
Degree of Soiling	3

Creator: JOKR1/PDP Released: IVSE1/PDP	Document: DB75009616EN Version: 01	Page 1 of 3
-------------------------------------------	---------------------------------------	-------------

75009616	DATA SHEET	
Valid from: 14.01.2019	EPIC® KIT H-A 4 SS MTS M20	

Approvals

VDE-Approval, VDE-REG.-Nr.
UL File Number
CSA File Number

B437
E75770
053004



Standards

Safety Standard

IEC 61984; UL 1977; CSA-C22.02

Technical Drawings

Housing

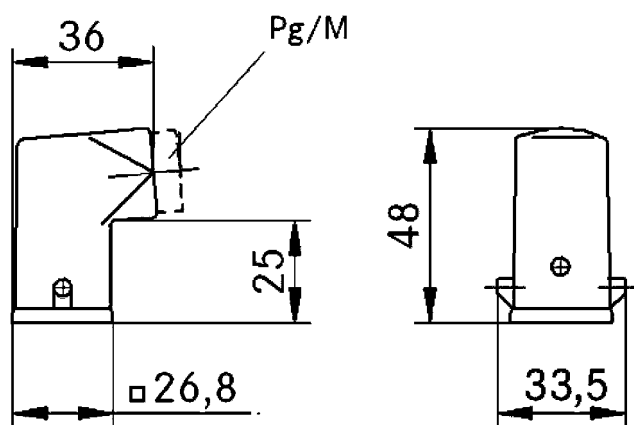

Insert

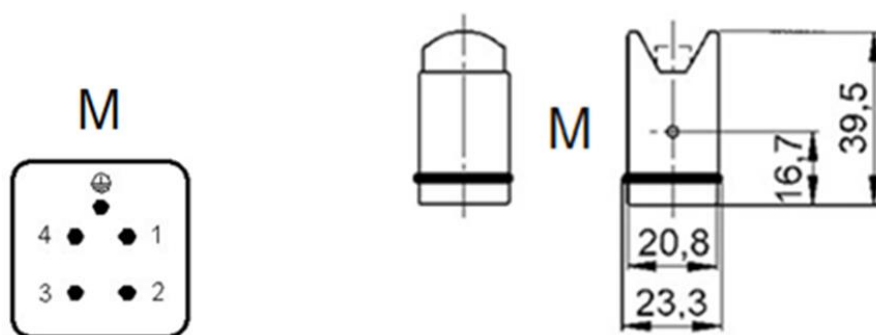

Creator: JOKR1/PDP Released: IVSE1/PDP	Document: DB75009616EN Version: 01	Page 2 of 3
-------------------------------------------	---------------------------------------	-------------

75009616	DATA SHEET	
Valid from: 14.01.2019	EPIC® KIT H-A 4 SS MTS M20	



Industrial machinery and plant engineering



Mechanical resistance



Robust



Waterproof



Assembly time



Space requirement

Info

Compact, robust metal housings size H-A 3
Robust power supply connector
Straight cable entry into the contacts

Application range

Machine and equipment manufacturing
Control engineering
Electronic laboratory

Remark

Photographs are not to scale and do not represent detailed images of the respective products.

Creator: JOKR1/PDP Released: IVSE1/PDP	Document: DB75009616EN Version: 01	Page 3 of 3
-------------------------------------------	---------------------------------------	-------------

75009618	DATA SHEET	
Valid from: 14.01.2019	EPIC® KIT H-A 4 BS MAG	

Description

- H-A inserts, easy to service, with screw termination up to 2.5 mm² wire cross section
- The small H-A is used whenever there is minimal space
- Easy cable connection with strait cable entry in the contacts.
- Optimally matched components
- Reduced ordering effort
- No wrong orders

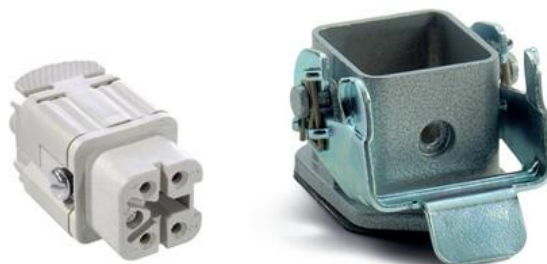

Components of the combination

Article number of the combination	75009618
Housing	H-A 3 MAG (10422500)
Insert	H-A 4 BS (10432000)

General characteristics

Series	H-A 4
Version	Female
Connection type	Screw termination
Pin-arrangement	4 + PE
Contact diameter	1 mm
Termination cross section	Screw termination: 0,5 – 2,5 mm ² (2,5 mm ² with wire end sleeve, depending on crimp profile)
Degree of protection (DIN EN 60529)	IP 65 (latched)
Degree of protection (NEMA 250/UL 50E)	12, 4 (latched)
Cycles of mechanical operation	100
Temperature range	-40°C to +125°C, short term up to +125

Materials and surfaces

Housing	Zinc die-casting
surface Housing	Powder-coating, grey
Insert	PA
Contact, base material	Copper alloy
Contact, surface	Hard-silver

Electrical characteristics

Rated Voltage, IEC	400 V
Rated Voltage, UL	600 V
Rated Voltage, CSA	600 V
Rated Impulse Voltage	4 kV
Rated Current, IEC	23 A
Rated Current, UL	10 A
Rated Current, CSA	10 A
Contact Resistance	1,5 - 4 mOhm
Degree of Soiling	3

Creator: JOKR1/PDP Released: IVSE1/PDP	Document: DB75009618EN Version: 01	Page 1 of 3
-------------------------------------------	---------------------------------------	-------------

75009618	DATA SHEET	
Valid from: 14.01.2019	EPIC® KIT H-A 4 BS MAG	

Approvals

VDE-Approval, VDE-REG.-Nr.
UL File Number
CSA File Number

B437
E75770
053004



Standards

Safety Standard

IEC 61984; UL 1977; CSA-C22.02

Technical Drawings

Housing

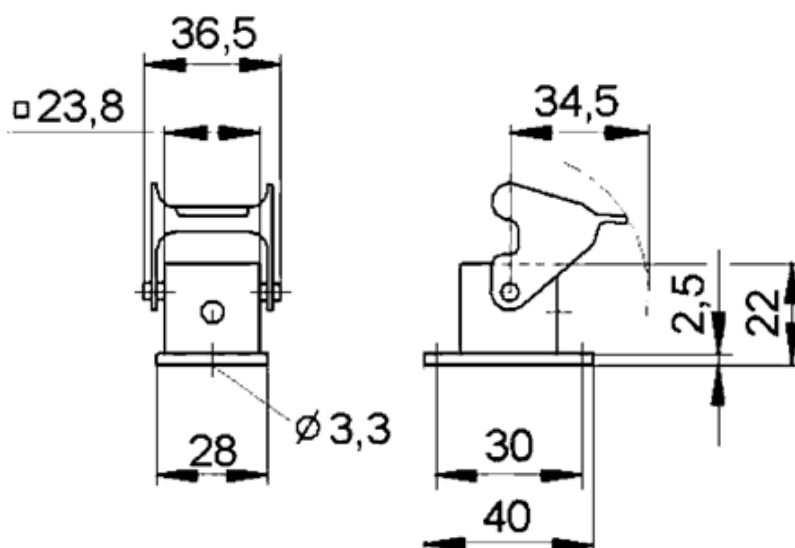

Insert

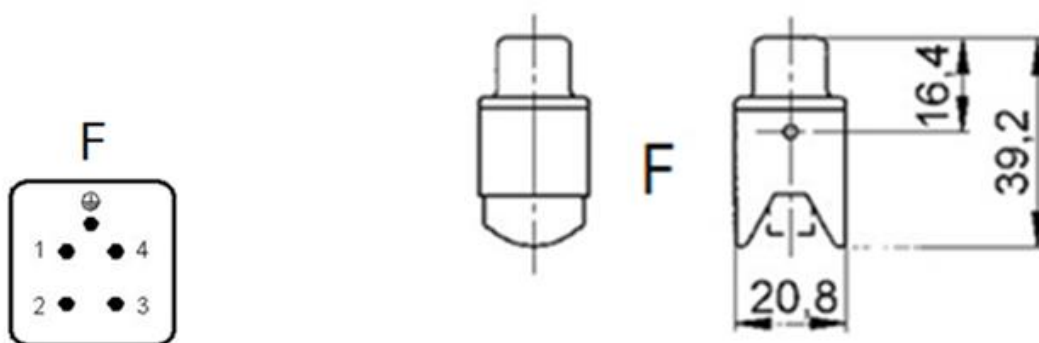

Creator: JOKR1/PDP Released: IVSE1/PDP	Document: DB75009618EN Version: 01	Page 2 of 3
-------------------------------------------	---------------------------------------	-------------

75009618	DATA SHEET	
Valid from: 14.01.2019	EPIC® KIT H-A 4 BS MAG	



Industrial machinery and plant engineering



Mechanical resistance



Robust



Waterproof



Assembly time



Space requirement

Info

Compact, robust metal housings size H-A 3
Robust power supply connector
Straight cable entry into the contacts

Application range

Machine and equipment manufacturing
Control engineering
Electronic laboratory

Remark

Photographs are not to scale and do not represent detailed images of the respective products.

Creator: JOKR1/PDP Released: IVSE1/PDP	Document: DB75009618EN Version: 01	Page 3 of 3
-------------------------------------------	---------------------------------------	-------------

75009620	DATA SHEET	
Valid from: 14.01.2019	EPIC® KIT H-A 4 BS MAGS	

Description

- H-A inserts, easy to service, with screw termination up to 2.5 mm² wire cross section
- The small H-A is used whenever there is minimal space
- Easy cable connection with strait cable entry in the contacts.
- Optimally matched components
- Reduced ordering effort
- No wrong orders

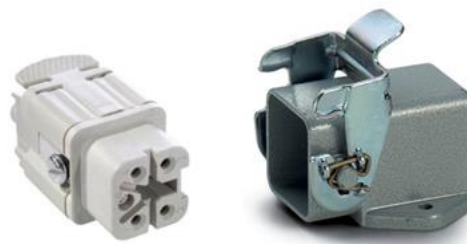

Components of the combination

Article number of the combination	75009620
Housing	H-A 3 MAGs (10423500)
Insert	H-A 4 BS (10432000)

General characteristics

Series	H-A 4
Version	Female
Connection type	Screw termination
Pin-arrangement	4 + PE
Contact diameter	1 mm
Termination cross section	Screw termination: 0,5 – 2,5 mm ² (2,5 mm ² with wire end sleeve, depending on crimp profile)
Degree of protection (DIN EN 60529)	IP 65 (latched)
Degree of protection (NEMA 250/UL 50E)	12, 4 (latched)
Cycles of mechanical operation	100
Temperature range	-40°C to +125°C, short term up to +125

Materials and surfaces

Housing	Zinc die-casting
surface Housing	Powder-coating, grey
Insert	PA
Contact, base material	Copper alloy
Contact, surface	Hard-silver

Electrical characteristics

Rated Voltage, IEC	400 V
Rated Voltage, UL	600 V
Rated Voltage, CSA	600 V
Rated Impulse Voltage	4 kV
Rated Current, IEC	23 A
Rated Current, UL	10 A
Rated Current, CSA	10 A
Contact Resistance	1,5 - 4 mOhm
Degree of Soiling	3

Creator: JOKR1/PDP Released: IVSE1/PDP	Document: DB75009620EN Version: 01	Page 1 of 3
-------------------------------------------	---------------------------------------	-------------

75009620	DATA SHEET	
Valid from: 14.01.2019	EPIC® KIT H-A 4 BS MAGS	

Approvals

VDE-Approval, VDE-REG.-Nr.
UL File Number
CSA File Number

B437
E75770
053004



Standards

Safety Standard

IEC 61984; UL 1977; CSA-C22.02

Technical Drawings

Housing

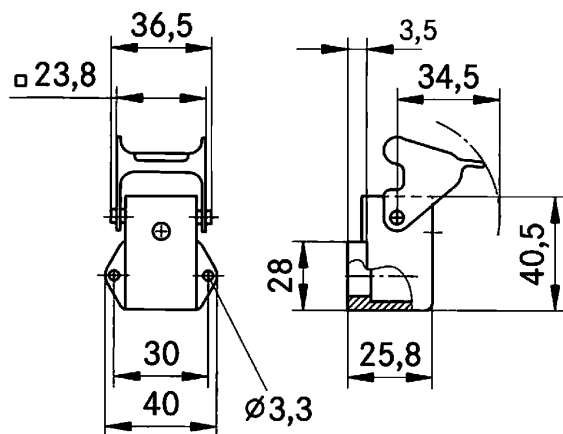

Insert

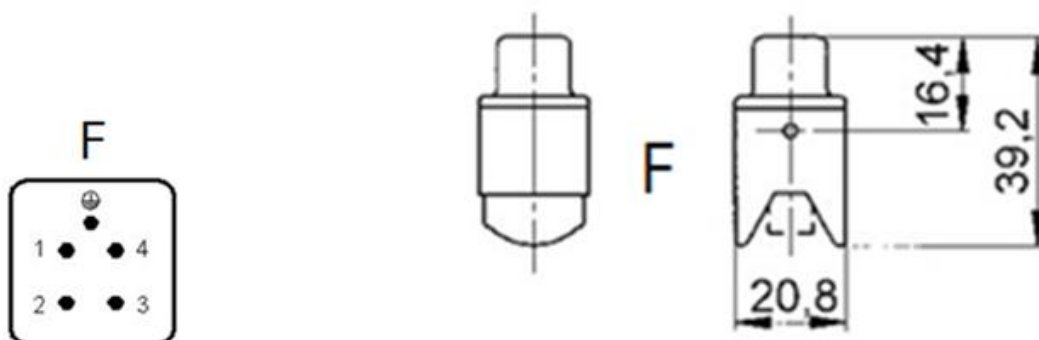

Industrial machinery and plant engineering

Creator: JOKR1/PDP Released: IVSE1/PDP	Document: DB75009620EN Version: 01	Page 2 of 3
-------------------------------------------	---------------------------------------	-------------

We reserve all rights according to DIN ISO 16016.
PD 0019/05_04.18EN

75009620	DATA SHEET	
Valid from: 14.01.2019	EPIC® KIT H-A 4 BS MAGS	



Mechanical resistance



Robust



Waterproof



Assembly time



Space requirement

Info

Compact, robust metal housings size H-A 3
Robust power supply connector
Straight cable entry into the contacts

Application range

Machine and equipment manufacturing
Control engineering
Electronic laboratory

Remark

Photographs are not to scale and do not represent detailed images of the respective products.

Creator: JOKR1/PDP Released: IVSE1/PDP	Document: DB75009620EN Version: 01	Page 3 of 3
-------------------------------------------	---------------------------------------	-------------

75009622	DATA SHEET	
Valid from: 14.01.2019	EPIC® KIT H-A 4 BS MAGSV M20 ZW	

Description

- H-A inserts, easy to service, with screw termination up to 2.5 mm² wire cross section
- The small H-A is used whenever there is minimal space
- Easy cable connection with strait cable entry in the contacts.
- Optimally matched components
- Reduced ordering effort
- No wrong orders

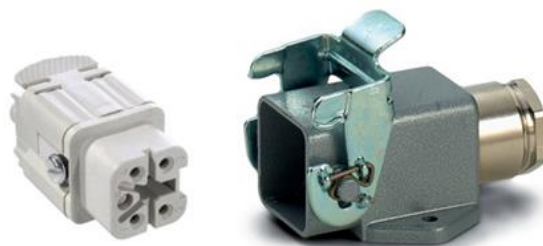

Components of the combination

Article number of the combination	75009622
Housing	H-A 3 MAGsv M20 ZW (19512700)
Insert	H-A 4 BS (10432000)

General characteristics

Series	H-A 4
Version	Female
Connection type	Screw termination
Pin-arrangement	4 + PE
Contact diameter	1 mm
Termination cross section	Screw termination: 0,5 – 2,5 mm ² (2,5 mm ² with wire end sleeve, depending on crimp profile)
Degree of protection (DIN EN 60529)	IP 65 (latched)
Degree of protection (NEMA 250/UL 50E)	12, 4 (latched)
Cycles of mechanical operation	100
Temperature range	-40°C to +125°C, short term up to +125

Materials and surfaces

Housing	Zinc die-casting
surface Housing	Powder-coating, grey
Insert	PA
Contact, base material	Copper alloy
Contact, surface	Hard-silver

Electrical characteristics

Rated Voltage, IEC	400 V
Rated Voltage, UL	600 V
Rated Voltage, CSA	600 V
Rated Impulse Voltage	4 kV
Rated Current, IEC	23 A
Rated Current, UL	10 A
Rated Current, CSA	10 A
Contact Resistance	1,5 - 4 mOhm
Degree of Soiling	3

Creator: JOKR1/PDP Released: IVSE1/PDP	Document: DB75009622EN Version: 01	Page 1 of 3
-------------------------------------------	---------------------------------------	-------------

75009622	DATA SHEET	
Valid from: 14.01.2019	EPIC [®] KIT H-A 4 BS MAGSV M20 ZW	

Approvals

VDE-Approval, VDE-REG.-Nr.
UL File Number
CSA File Number

B437
E75770
053004



Standards

Safety Standard

IEC 61984; UL 1977; CSA-C22.02

Technical Drawings

Housing

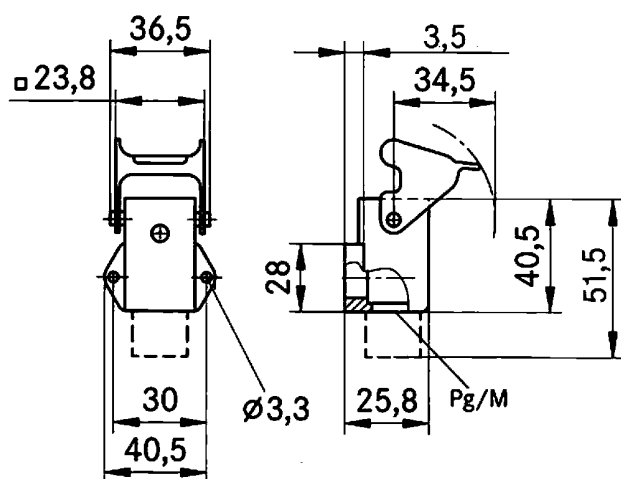

Insert

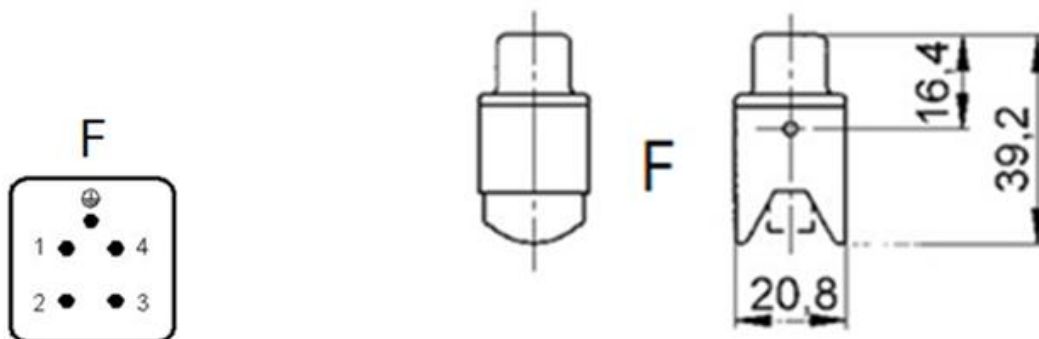

75009622	DATA SHEET	
Valid from: 14.01.2019	EPIC® KIT H-A 4 BS MAGSV M20 ZW	



Industrial machinery and plant engineering



Mechanical resistance



Robust



Waterproof



Assembly time



Space requirement

Info

Compact, robust metal housings size H-A 3
Robust power supply connector
Straight cable entry into the contacts

Application range

Machine and equipment manufacturing
Control engineering
Electronic laboratory

Remark

Photographs are not to scale and do not represent detailed images of the respective products.

Creator: JOKR1/PDP Released: IVSE1/PDP	Document: DB75009622EN Version: 01	Page 3 of 3
-------------------------------------------	---------------------------------------	-------------

75009624	DATA SHEET	
Valid from: 14.01.2019	EPIC® KIT H-A 4 BS MTGVB M20	

Description

- H-A inserts, easy to service, with screw termination up to 2.5 mm² wire cross section
- The small H-A is used whenever there is minimal space
- Easy cable connection with strait cable entry in the contacts.
- Optimally matched components
- Reduced ordering effort
- No wrong orders



Components of the combination

Article number of the combination	75009624
Housing	H-A 3 MTgVB M20 (19512900)
Insert	H-A 4 BS (10432000)

General characteristics

Series	H-A 4
Version	Female
Connection type	Screw termination
Pin-arrangement	4 + PE
Contact diameter	1 mm
Termination cross section	Screw termination: 0,5 – 2,5 mm ² (2,5 mm ² with wire end sleeve, depending on crimp profile)
Degree of protection (DIN EN 60529)	IP 65 (latched)
Degree of protection (NEMA 250/UL 50E)	12, 4 (latched)
Cycles of mechanical operation	100
Temperature range	-40°C to +125°C, short term up to +125

Materials and surfaces

Housing	Zinc die-casting
Housing, surface	Powder-coating, grey
Insert	PA
Contact, base material	Copper alloy
Contact, surface	Hard-silver

Electrical characteristics

Rated Voltage, IEC	400 V
Rated Voltage, UL	600 V
Rated Voltage, CSA	600 V
Rated Impulse Voltage	4 kV
Rated Current, IEC	23 A
Rated Current, UL	10 A
Rated Current, CSA	10 A
Contact Resistance	1,5 - 4 mOhm
Degree of Soiling	3

Creator: JOKR1/PDP Released: IVSE1/PDP	Document: DB75009624EN Version: 01	Page 1 of 3
-------------------------------------------	---------------------------------------	-------------

75009624	DATA SHEET	
Valid from: 14.01.2019	EPIC® KIT H-A 4 BS MTGVB M20	

Approvals

VDE-Approval, VDE-REG.-Nr.
UL File Number
CSA File Number

B437
E75770
053004



Standards

Safety Standard

IEC 61984; UL 1977; CSA-C22.02

Technical Drawings

Housing

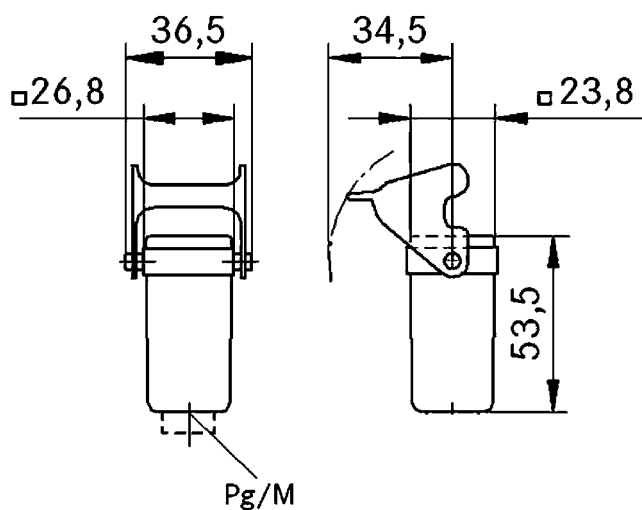

Insert

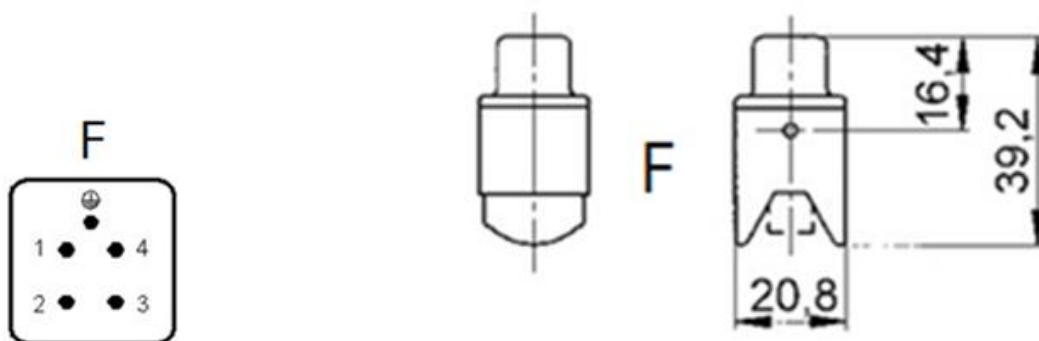

Creator: JOKR1/PDP Released: IVSE1/PDP	Document: DB75009624EN Version: 01	Page 2 of 3
-------------------------------------------	---------------------------------------	-------------

75009624	DATA SHEET	
Valid from: 14.01.2019	EPIC® KIT H-A 4 BS MTGVB M20	



Industrial machinery and plant engineering



Mechanical resistance



Robust



Waterproof



Assembly time



Space requirement

Info

Compact, robust metal housings size H-A 3
Robust power supply connector
Straight cable entry into the contacts

Application range

Machine and equipment manufacturing
Control engineering
Electronic laboratory

Remark

Photographs are not to scale and do not represent detailed images of the respective products.

Creator: JOKR1/PDP Released: IVSE1/PDP	Document: DB75009624EN Version: 01	Page 3 of 3
-------------------------------------------	---------------------------------------	-------------